

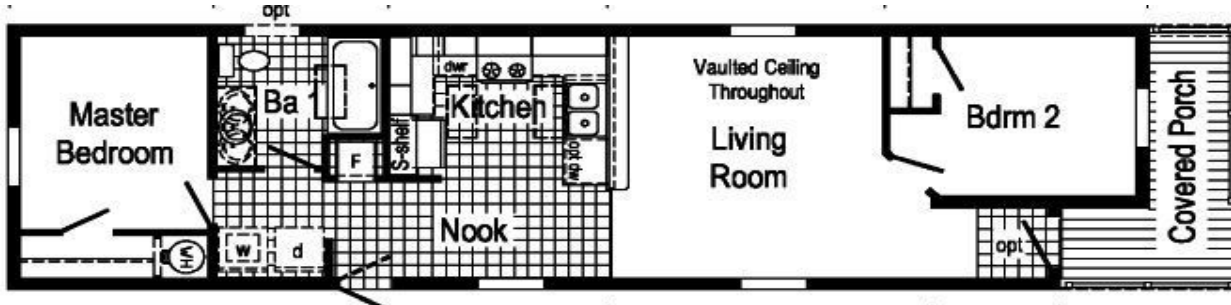

8 US Highway Route 1
 Ellsworth, Me 04605
 www.coastlinehomes.net
 207-667-0664



#5 14 x 58 Commodore Blazer TS114A



**WE OFFER FULL GENERAL CONTRACTING SERVICES
 AND END LOAN AVAILABILITY**

Contact us at
ralph@coastlinehomes.net
 Or
scott@coastlinehomes.net

Building BUDGET FRIENDLY homes with integrity and 30 YEARS of building EXPERIENCE!

2-Axles w/breaks replacing idler axles	180.00	2-photo electric smoke & carbon monoxide detector	180.00
1-extra axle w/break	250.00	Wind wrap barrier on exterior walls	195.00
Oil gun furnace	350.00	1-Delux electric Frigidaire refrigerator (Black)	50.00
1-Stack extension for furnace	35.00	Finished drywall T/O	2,795.00
Water shut off valves T/O	75.00	Entry foyer vinyl floor	60.00
1-9lite steel rear door	350.00	Add backsplashes to kitchen & bath counters	95.00
1-Sunburst steel front door	175.00	Cabinet doors White Stratford MDF	695.00
1-window master bath	250.00	1-wire shelf over laundry	35.00
1-window bed room 2 facing porch	250.00	1-60" fiberglass tub in master bath	160.00
40# roof 16"O.C rafters & floor joist	720.00	2-china sinks T/O	110.00
Wind zone II specifications	320.00	1-double lav sinks	80.00
1-ceiling lights 1 in each bed room	90.00	New England code	50.00
1-Telephone jack	45.00	Energy star package	395.00
1-TV jack	45.00	Stretch home 2' to make 58'	575.00

*Pricing and options are subject to change without notice- we custom quote every home to ensure accurate costing. Plus sales tax where applicable.

OUR PRICING INCLUDES: DELIVERY AND SET WITHIN 100 MILES, WHITE VINYL SKIRTING AND TIE DOWNS INSTALLED

Standards & Features

Interior

Stipple Ceiling
Vaulted Ceiling Throughout
7'0" Sidewall Height
Vinyl Wall Covering on Gypsum
Carpet Throughout Except Kitchen,
Utility, & Baths
Rebond Carpet Pad
Vinyl Flooring per Model
Metal Interior Passage Sets
Pre-Hung Door Jambs
White 6-Panel Interior Doors with 2
Mortised Hinges
Floor Mount Door Stops
Smoke Detectors with Battery
Back-Up
Ceiling Light with Alabaster Glass

Kitchen

Georgetown Oak Cabinetry
Lined Overhead Cabinets
Base Shelf in Kitchen Base
Cabinets
Undermount Drawer Guides
Mission Cabinet Doors with Brushed
Nickel Cabinet Hardware
Hidden Hinges on Cabinets
High Pressure Laminate
Countertops with Laminate
Edging
Stainless Steel Sink
Utopia Chrome Faucet

Appliances

30" Gas Range
Power Range Hood with Light
18 Cu.Ft. No-Frost Refrigerator

Baths

60" Tub/Shower
1.6 Gallon Per Flush Toilets
High Pressure Laminate
Countertops with Laminate
Edging
Lighted Vent Fan in Each Bath
Brushed Nickel Cabinet Hardware
Base Shelf in Vanities
33" High Bath Vanities

Bedrooms

Switched Receptacles
Egress Window in Each Bedroom
Wire Shelving in Wardrobes

Utilities

Plumb for Washer with Quarter
Turn Valve
Wire and Vent for Electric Dryer
100 AMP Electrical Service
30 Gallon Electric Water Heater
Gas Furnace with Air Exchanger
Aluminum Heat Ducts
Copper Wiring Throughout
Main Water Line Shut-Off Valve
Air Conditioning Ready Thermostat
with 5-Wires

Insulation

R-14 Fiberglass Insulation in Floor
R-19 Fiberglass Insulation in Walls
R-25 Avg. Blown Insulation in Ceiling
Singles Section Homes
R-28 Avg. Blown Insulation in Ceiling
Ranch Homes

Exterior

Brushed Nickel Square Lantern Light
at Front Door
Vinyl Exterior Siding with
Sheathing Board
One GFI-Protected Exterior Receptacle
Shingle Roof with Vented Soffits
and Ridge Vent
34x76 House-Type Front Door with Storm
Vinyl Windows
Window Trim Between Non-Mulled Windows
12" Raised Panel Shutters on Front Door Side

Construction

Transverse Floor System:
2x6 on 14 & 28 Wide Models
2x8 on 16 Wide Models
2x6 Exterior Walls on 16" Centers**
20# Roof Load
¾" T&G OSB Floor Decking